

# S330V



  
SEALINE



SEALINE S330v

SPORTINESS PAIRED  
WITH EXCELLENCE





# SEALINE S330v



## LARGE BATHING PLATFORM

Celebrate life on the water in full comfort. The teak-floored bathing platform is the perfect starting point for taking a swim, diving or other activities.

## DYNAMIC, SLEEK DESIGN

From the roof line to the hull shape, you'll get enthusiastic about the sporty aesthetics. Feel them with every glance. With every metre of the way.

## FUN-TO-DRIVE OUTBOARDS

Driving the S330v is spontaneous and entertaining. The outboards' quiet operation ensures life on board to be a pleasure.

## HANDCRAFTED LUXURY INTERIOR

Enjoy exquisite style down to the smallest seam. The exclusivity of the interior can be seen in every detail and felt with every touch.

## CLASS-LEADING INTERIOR SPACE

Outstanding dimensions. Among all the sport yachts in the 33-foot class, the Sealine S330v offers the most spacious beds and standing height below deck.

## TWO GENEROUS SUN LOUNGES

Sunbathing for all your guests. In addition to the sunbed at the bow the rear settee can be transformed into a comfortable lounge.





TREND-SETTING DESIGN

## GET IMPRESSED BY TRUE POWER – 2 X 300 HP SPEED UP YOUR PULSE

The new Sealine S330v is here, ready to exceed your expectations. She takes her light, thrillingly dynamic design from the celebrated Sealine S330. Her breathtaking performance is delivered by two powerful outboard engines just waiting to get going. The excellent response characteristics and steering precision of the outboards will tempt you to enjoy intuitive driving manoeuvres. Discover the Sealine S330v today. Typical Sealine. Excitingly different.





enjoy the  
**LIGHT**

feel the  
**SPACE**

combine functionality with  
**DESIGN**

All Sealine yachts are born of the same values: they feature wide interior spaces, an amazing quantity of natural light and outstanding design with German engineering inside. As for these trademarks, the S330v displays the true spirit of Sealine.





## WHATEVER YOU LIKE TO ENJOY – THE S330v IS THE PLACE TO BE

Bathing, soaking up the sun, barbecuing: the Sealine S330v has all it takes to satisfy every desire that comes to your mind. Extra-large sunbeds can be placed in the bow section. The cockpit table easily converts into another sunbed, making it possible to invite four guests to relax outside – at the same time. Onboard of this sports cruiser, the sun shines for everyone.







Thanks to the open stern and partially glassed sides, the Sealine S330v provides you with lovely sun and fresh sea air at all times. When you slide open the sunroof and retract the bimini over the cockpit, you will get the maximum of daylight. To make the summer feeling complete, you can enjoy countless amenities of grand comfort, including a gas grill, two sun lounges and a bathing platform. No doubt: the Sealine S330v already fulfills your every desire for luxury.

## SEALINE S330v





Instant throttle response. Precise steering characteristics. Awesome sportiness and acceleration. If you expect your driving experience to be most spontaneous, the outboard-powered Sealine S330v will arouse all your enthusiasm. Her low draught allows manoeuvring, snorkeling or bathing close to the coast. In addition to these benefits, steering the yacht when reversing is beautifully simple.







## FOR A PERFECT MATCH, TAKE THE BEST OF EVERYTHING

At a length of 33 feet, the Sealine S330v provides everything you would expect from a supremely comfortable motor yacht. A full-featured galley, a luxurious saloon and two double cabins, all designed in an elegant yet modern style. Once inside, you realise why light switches are rarely used before sunset. Large hull windows provide abundant natural light – as well as wonderful views to the maritime scenery beyond.

The S330v features an interior so versatile that it is defined only by your needs. For example, you can order your yacht with or without bulkhead between the saloon and forward cabin – and you still have the benefit of a separate cabin in the rear.





## TAKE A SEAT – AND THEN TAKE OFF

One of Sealine's trademarks is to arrange the instruments in a way that brings ergonomics and style into perfect balance. The helm station is a designer piece in itself, adding a spectacular touch to the space with its gleaming, chrome fittings. The joy of driving can be shared by two thanks to the twin co-pilot seat on the port side.





**BOAT MONITOR**

- FRIDGE**  
Turn on/off remotely
- LIGHTS**  
Turn on/off
- HATCH/DOOR SENSOR**  
Monitor unauthorised access
- SHORE POWER**  
Monitor connection
- ENGINE**  
Monitor activity
- MOTION SENSOR**  
Collision and grounding detection
- FUEL TANK**  
Monitor level
- WATER TANK**  
Monitor level
- BATTERY BANK**  
Monitor level
- GPS, WIND AND SPEED DATA**
- ANCHOR WINCH**  
Monitor activity
- BOW THRUSTER**  
Monitor activity
- BILGE PUMP**  
Monitor activity

\*Control and sensors depend on the configuration of your Sealine.

# MY SEALINE SAFETY CLOUD

## YOUR ENTIRE YACHT IN YOUR HAND

Everyone is talking about the digital future. But Sealine is implementing it – with the first cloud-based telematics system for series production motor yachts. You can access your boat's technical data and functions live via the mobile app or via the owner's area at [www.sealine.com](http://www.sealine.com)

Intelligent functions such as BoatMonitoring, eLogbook and eServicebook enable you to keep an automatic logbook, stay on top of all servicing dates and monitor your yacht seamlessly.

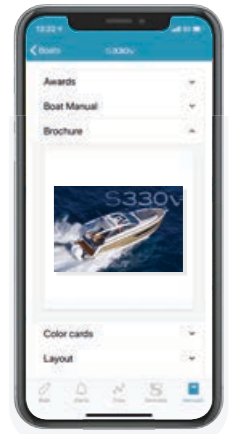

## MANUALS

All manuals and instructions within one app.

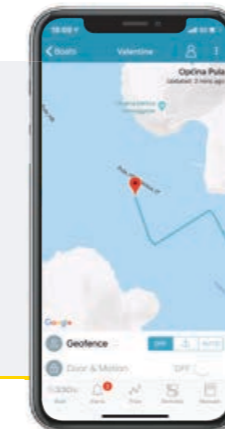

## POSITION

Track your position in real time.

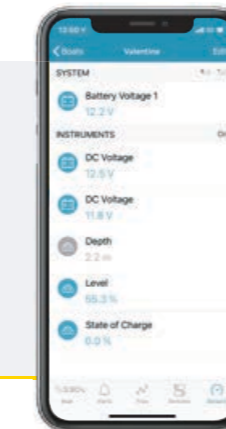

## SENSORS

Monitor your charge levels and devices.

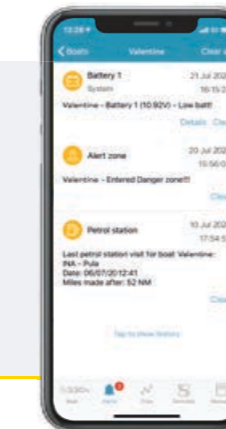

## ALARMS

Push notifications on current events.

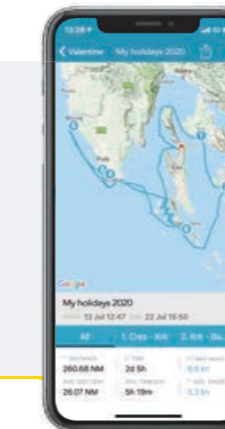

## TRIP LOG

Share your cruises and track data with friends.

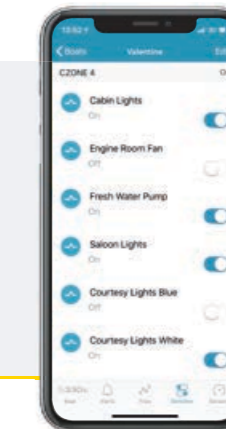

## CONTROL

Operate your electronic devices by remote control.



## LIVE REPORT

Direct contact to your dealer for quick help.



# SEALINE S330v



## POWERED BY 2 X 300 HP

Because outboards release all their power in the exact direction you steer, they are very agile and great fun to drive. Being able to lift the entire motor out of the water also makes maintenance very easy.



## LAMINATED POWER GRID

The hull reinforcements of the Sealine S330v are elaborately laminated – giving you the advantages of a high-strength yacht with a reduced weight.

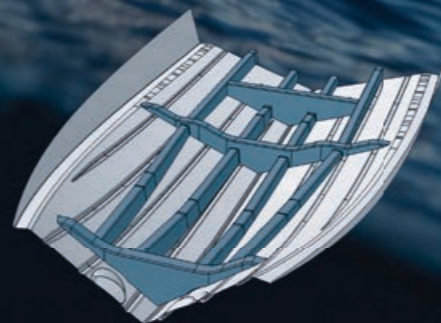

## DEEP V-SHAPE KEEL

The Sealine S330v hull has a deep-V shape. This means the Sealine is exceptionally stable in the water, making for more comfortable boating.

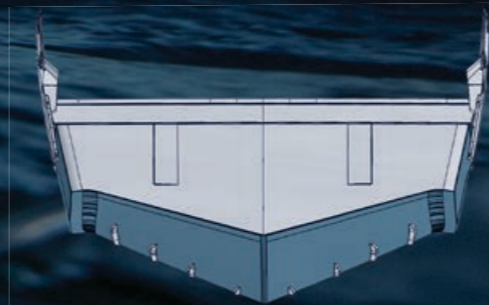

## UPRIGHT STEM

The vertical bow with its curved foot pierces the waves elegantly and efficiently. This, in turn, results in more comfort and more boating pleasure.







PRINCIPAL DIMENSIONS (according to ISO 8666)

|                                   |         |            |
|-----------------------------------|---------|------------|
| Length Overall – ext. platf.      | 11.01 m | 36' 1"     |
| Length of Hull                    | 10.07 m | 33' 0"     |
| Beam                              | 3.50 m  | 11' 4"     |
| Height above waterline incl. mast | 3.45 m  | 11' 3"     |
| Height above waterline excl. mast | 2.73 m  | 8' 11"     |
| Draught (Tmax)                    | 0.94 m  | 3' 1"      |
| Fuel capacity                     | 570 l   | 125 UK gal |
| Water capacity                    | 220 l   | 48 UK gal  |
| Displacement                      | 7.06 t  | 6.95 UK t  |
| CE Category                       | B       |            |
| Max. person                       | 8       |            |

ENGINE OPTIONS

2 x 300 hp, outboard engines

36 knots\*

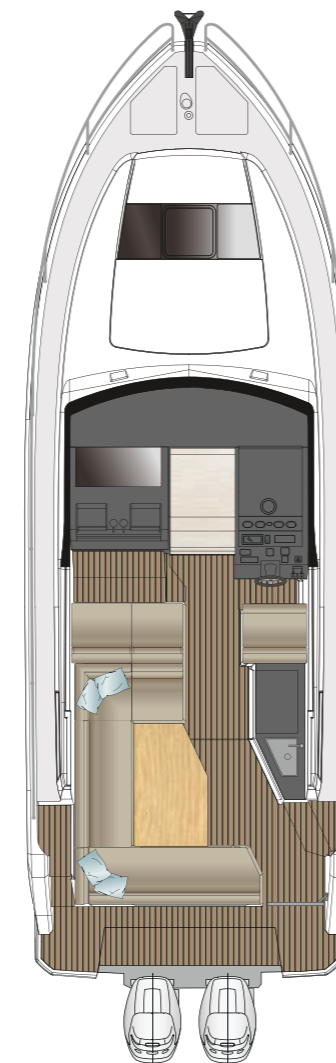

MAIN DECK



MAIN DECK  
option

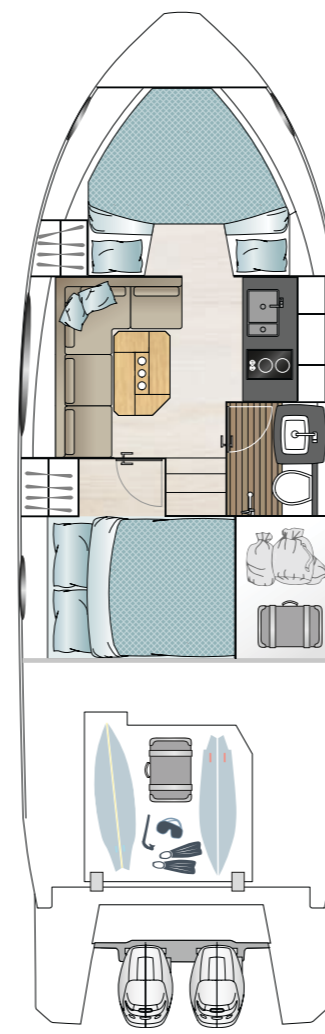

LOWER DECK

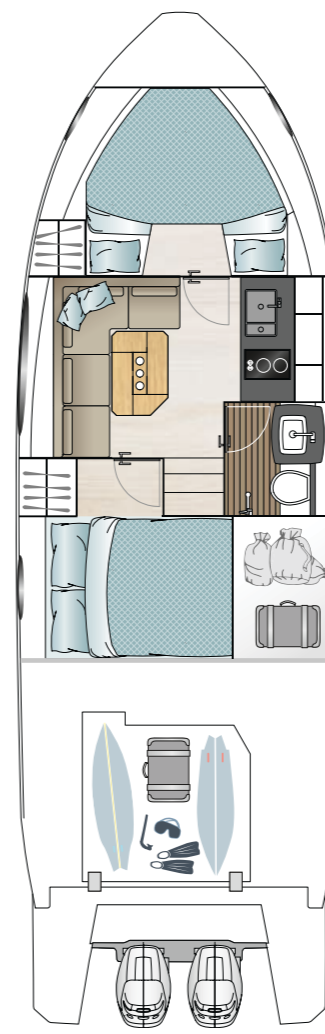

LOWER DECK  
option

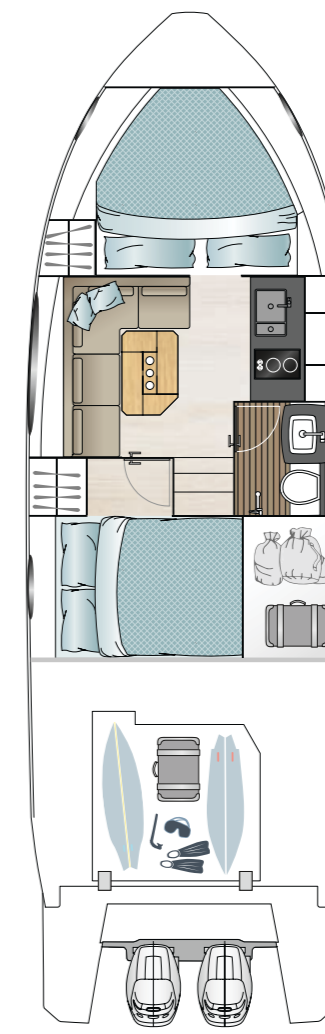

LOWER DECK  
option

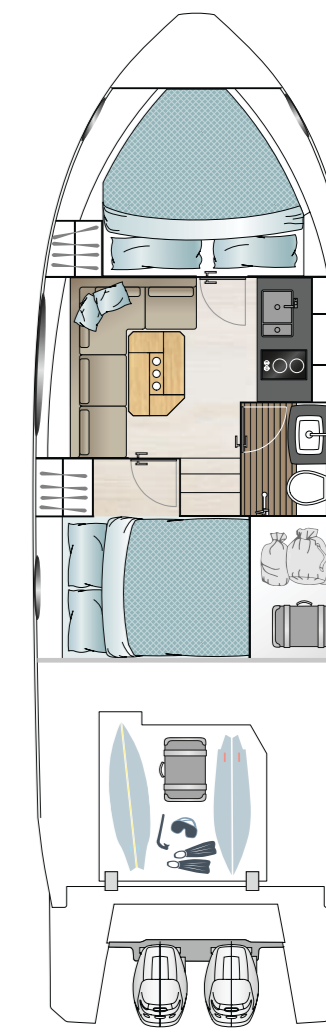

LOWER DECK  
option

A1

A2

A3

A4

B1

B1

B1

B1

\* All performance figures are given in good faith and are intended as an indication. These figures cannot be guaranteed as top speed in particular is affected by the cleanliness of the hull, conditions of the propellers, weight carried and air/sea temperature. Performance is related also to the optional accessories selected. SEALINE reserves the right to change specifications in line with the company policy of improvement through research and development. Errors and omissions expected. Please check with your dealer for a full list of inclusions. This brochure is not contractual. The yachts depicted partly comprise special equipment not included in the standard scope of supply. Illustrations may not correspond with current versions. Subject to alterations in design and equipment without notice and errors excepted. Photos: Nico Krauss. Print: EGGERSDRUCK. Artwork: smz GmbH.



# LIMITLESS VARIETY

---

# MATCHLESS QUALITY

The manufacturing quality of the Sealine S330v is a multi-sensory experience. Exquisite materials spoil the eye with every glance. A subtle scent of finest leathers blends with the pleasing feel of elegant woods. Anything you see or touch was masterfully handcrafted by superb boat builders. Enjoy an exclusive atmosphere that can only be created by the perfect match of sophisticated details.

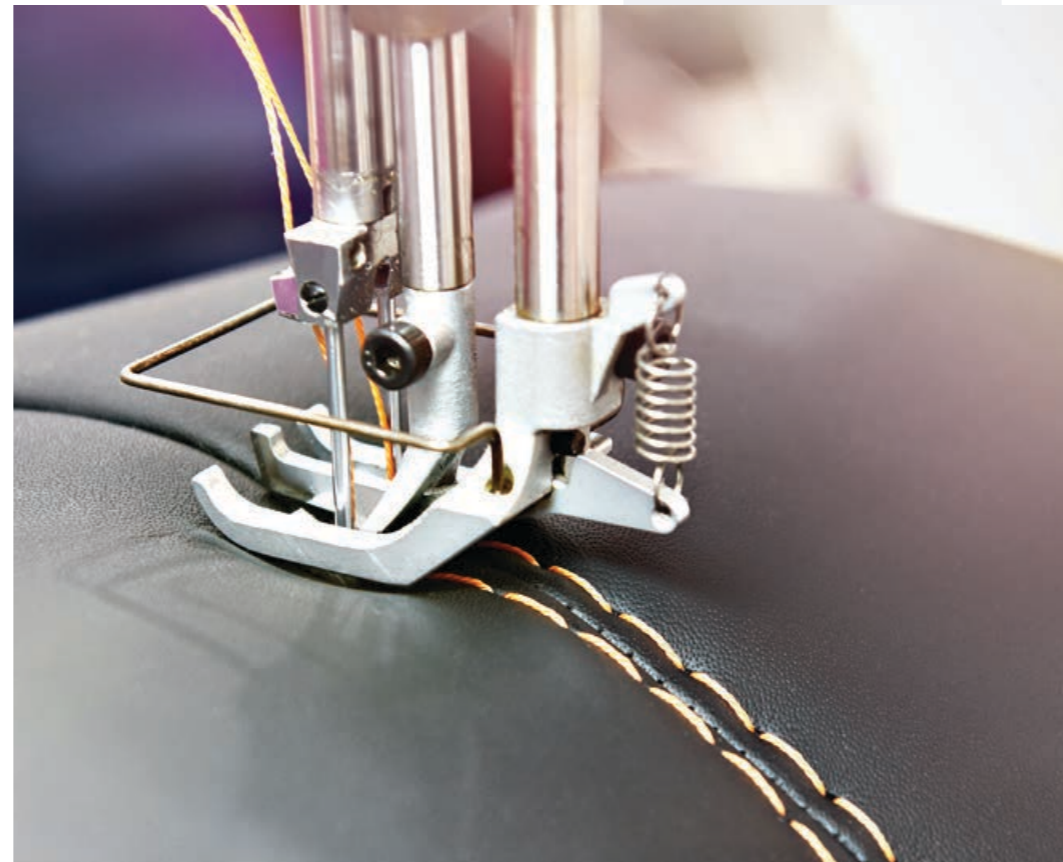

## EACH SEALINE IS ONE OF A KIND

With your personal selection of colours and textures, you transform your Sealine into a unique expression. Five teak variants are available for the deck alone. We also offer special materials for cockpit seats and sun cushions. For the interior you can choose between different furniture woods, upholstery and curtains, while underfoot, select from wood or carpet.





## GERMAN PRECISION AND PASSION FOR THE SEA. THAT'S WHAT A SEALINE IS MADE OF.

In 2013, the Sealine brand found a worthy new home on the German Baltic coast. At our shipyard in Greifswald, we have perfected the interplay between state-of-the-art manufacturing techniques and skilled employees.

The outstanding people in our team perform their work with enormous experience, a deep understanding of the customer and great dedication.

In addition, we are thrilled to cooperate with our British partner Bill Dixon. Working closely with our in-house experts, the award-winning designer is creating a new range of innovative Sealine models.

Above all, we believe that what holds true for the experienced boater, also holds true for us as boat builders. Beyond the individual skill, there is something which genuinely binds all of us at Sealine: A great passion for the sea.





## DROP ANCHOR AT SEALINE

YOUR LOCAL SEALINE DEALER IS LOOKING FORWARD TO YOUR VISIT.





CRUISER SERIES



C330



C390



C430



C530

FLYBRIDGE SERIES



F430



F530

OUTBOARD V-SERIES



S330v



C330v



C390v

SPORT SERIES



S330



S430



[www.sealine.com](http://www.sealine.com)

Sealine Ladebower Chaussee 11 D-17493 Greifswald