

SPECIFICATION



LOA		15.30 m	50' 2"
Hull length		14.85 m	48' 9"
LWL		13.45 m	44' 2"
Beam		4.75 m	15' 7"
Draft			
shallow keel		1.98 m	6' 6"
L-keel, medium		2.38 m	7' 10"
T-keel, medium		2.38 m	7' 10"
Displacement			
shallow keel	approx.	14.90 t	32.849 lbs
T-keel, medium	approx.	14.40 t	31.747 lbs
L-keel, medium		14.50 t	31.967 lbs
Engine Diesel			
standard	approx.	75.00 PS	75.00 hp
Fuel tank	approx.	280 l	74 gal
Fresh water	approx.	630 l	166 gal
CE Certificate	A - 12		
Design	judel / vrolijk & co		
Interior	HanseYachts Design		
Mast length above WL	approx.	22.10 m	72' 6"
Total sail area	approx.	119.00 m ²	1281 sq ft
Main sail			
standard	approx.	67.50 m ²	727 sq ft
furling	approx.	62.50 m ²	673 sq ft
Self-tacking jib	approx.	51.50 m ²	554 sq ft
CrossOver	approx.	106.80 m ²	1150 sq ft
Gennaker	approx.	163.00 m ²	1755 sq ft

505

Model year 2018. Valid from 2018.04.01. All measurements/figures are approximate. Errors and omissions excepted. Specification and material can be changed without notice.

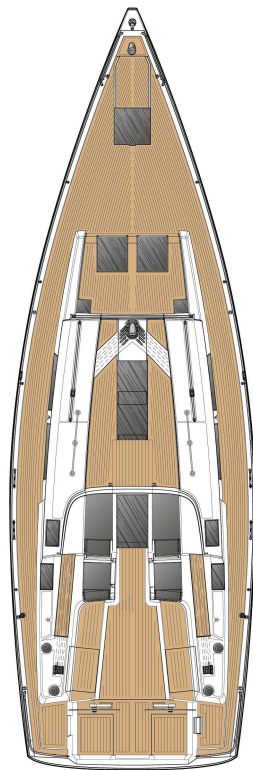

Standard



Option



Option

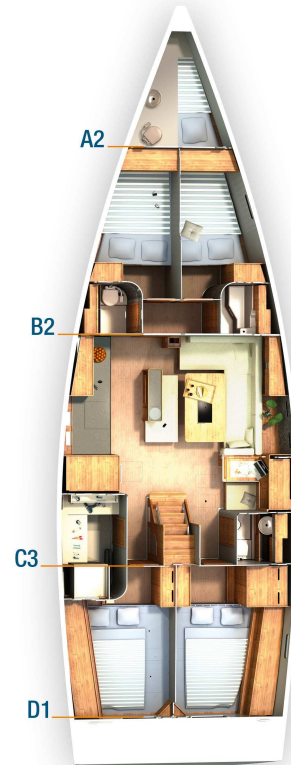

Option

HULL

- 8 hull windows (4 each side)
- GRP hull, isophthalic gelcoat, colour: Signal White (RAL 9003), 1st layer vinyl ester resin with balsa sandwich core.
- Waterline and cove line, isophthalic gelcoat, colour: Dark Grey (RAL 7043)

KEEL

- T-keel, cast iron, draft: 2.38 m
- GRP rudder with seawater resistant aluminium shaft and self-aligning bearings

LAYOUT & INTERIOR

- A1: Sail locker with extensive storage space
- B1: Master cabin with island double berth, storage space and a head with separate shower stall
- C1: Saloon with galley on port, dining area on stb, bunk bed cabin and aft head
- D1: 2 aft cabins with double berth, storage and hanging locker
- 3-burner gas stove with oven, waste bin, 12 V fridge approx. 130 l, double stainless steel sink with mixing tap
- Interior furniture in high quality marine plywood, Satin Varnish
- Hanse companionway closing system
- Saloon table, folding
- Worktop in galley - Black Quartz

WOOD (FURNITURE, FLOORBOARD)

- Furniture - Mahogany Style, Satin Varnish
- Floorboard - Acacia

UPHOLSTERY, CARPETS & CURTAINS

- Mattresses for all berths
- Upholstery - Monte Carlo, colour: Cream

DECK & OUTSIDE EQUIPMENT

- GRP deck with antislip surface, isophthalic gelcoat, colour: Signal White (RAL 9003), 1st layer vinyl ester resin with balsa sandwich core. 1 cockpit locker on port and stb, stern locker port and stb, stowage for running rigging at helm position, anchor locker at bow.
- Teak on cockpit benches
- Teak on bathing platform

- Twin wheel steering system with emergency tiller
- 2 stainless steel steering wheels with leather cover
- Cockpit table, stainless steel with folding teak tops
- Pulpit and pushpit, stainless steel
- Railing, incl. stanchions and stainless steel wire
- Covered halyards and control lines lead to cockpit helm position, organizers and jammers, 6 retractable mooring cleats, handrail on coach roof, bow anchor fitting with step
- 2 LEWMAR 55 ST EVO manual halyard winches
- 2 LEWMAR 55 ST EVO manual secondary winches
- Bathing platform, manual fold-out with swimming ladder
- Life raft storage
- Self tacking jib system
- Mainsheet system
- 7 large and 6 small deck hatches - openable, anchor locker hatch, stowage on coach roof with acrylic glass hatch
- 4 deck coach roof windows - 4 openable, acrylic glass next to companionway, portlights in cockpit side for aft cabins

RIG & SAILS

- Rig, anodized aluminium, deck stepped, with kicker, standing and running rigging and 2 reefs
- ELVSTRÖM Dacron sails - full battened, main and jib

NAVIGATION & INSTRUMENTS

- Illuminated compass at each helm
- Navigation lights - LED

PROPULSION

- Fuel tank, approx. 280 l
- Engine (Diesel, approx. 75 hp) - saildrive, 3-blade fix propeller

EQUIPMENT

- 12 V and 230 V electric system with 230 V shore power and sockets in cabins and heads
- AGM battery set, capacity: 1x 90 Ah + 2x 160 Ah AGM
- Country Version: EU / AUS
- Battery charger 70 A
- LPG gas system, stowage for 1 bottle
- Blackwater system (appr. 35 l) with deck extraction and seacock for head, electric and manual bilge pump

- Freshwater system with electric pump and 20 l hot water, heated by main engine
- Fresh water tank, appr. 630 l

ACCESSORIES

- Mast steps

SHIPPING & TRANSPORT

- CE - Certificate cat. A - 12
- Owners manual
- EC - Type Examination Certificate