

SPECIFICATION



LOA	approx.	11.32 m	37' 2"
Hull length	approx.	10.60 m	34' 9"
LWL	approx.	10.29 m	33' 9"
Beam	approx.	3.99 m	13' 1"
Draft			
T-keel, medium	approx.	2.15 m	7" 1"
Displacement			
T-keel, medium	approx.	8.37 t	18,453 lbs
Engine			
Diesel-standard	approx.	29.00 PS	29.00 hp
Diesel-option	approx.	39.00 PS	39.00 hp
Electric 18kW/h	approx.	25 kW	25 kW
Electric 36kW/h	approx.	25 kW	25 kW
Fuel tank	approx.	160 l	42 gal
Fresh water	approx.	345 l	91 gal
Mast length above WL	approx.	17.60 m	57' 9"
Total sail area	approx.	73.00 m ²	787 sq ft
Main sail	approx.	40.00 m ²	431 sq ft
Self-tacking jib	approx.	28.00 m ²	301 sq ft
Genoa	approx.	33.00 m ²	355 sq ft
Crossover	approx.	71.00 m ²	764 sq ft
Gennaker	approx.	112.00 m ²	1,206 sq ft

CE Certificate	A-6
Design	Berret - Racoupeau
Interior	Berret - Racoupeau

360ST

All measurements/figures are approximate. Errors and omissions excepted. All weights are specified in MLC. Specification and material can be changed without notice. Valid from 2025.04.24. Only for PROTOTYPES

360ST DECK LAYOUT & CABIN CONCEPT

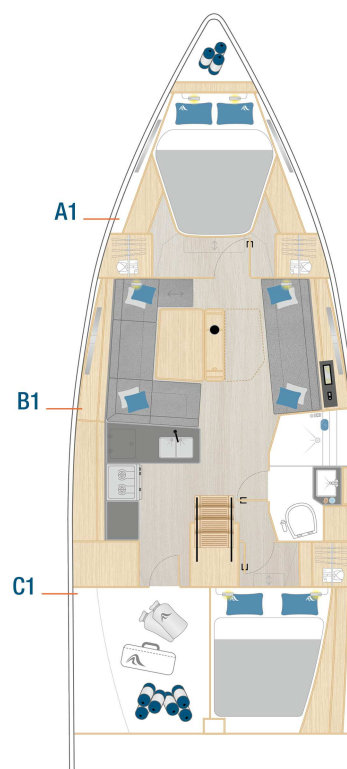
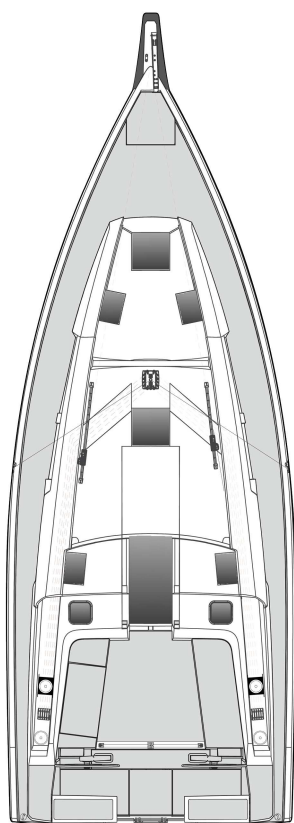

Standard

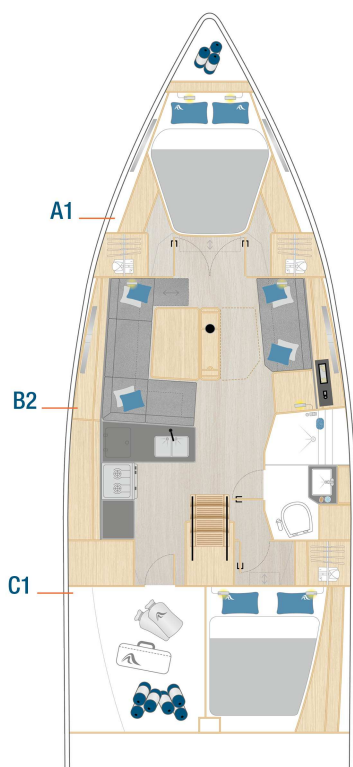

Option

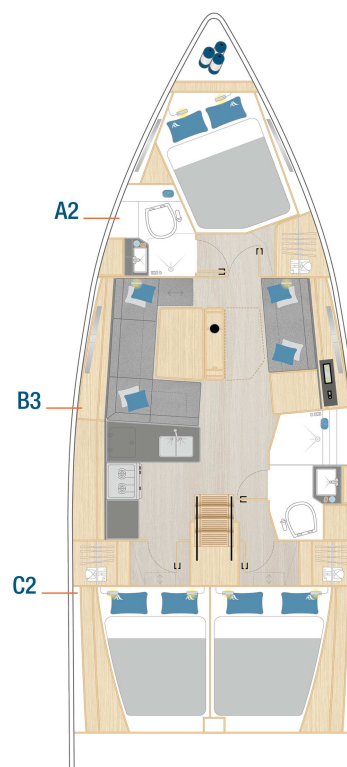

Option

HULL

- 6 hull windows (3 each side) similar like hull colour
- GRP hull, isophthalic gelcoat, colour: Signal White (similar RAL 9003), 1st layer vinyl ester resin and balsa sandwich laminat
- Waterline, isophthalic gelcoat, colour: Dark Grey (similar RAL 7043)

KEEL

- T-keel, cast iron, draft: 2.15 m
- ST-Line GRP rudder with stainless steel shaft and selfaligning bearings

LAYOUT & INTERIOR

- A1: Master cabin with island double berth and storage space
- B1: Saloon with large dining area on port and sofa on stb
- C1: Large L-galley and storage space on port. Head with separate shower stall, aft cabin with double berth, locker and storage on stb
- 2-burner gas stove with oven, waste bin, 12 V fridge approx. 135 l, double stainless steel sink with mixing tab
- Interior Design package ST-Line (black watertap, black reading lights, black down lights, black mast pole, black handrails). Interior furniture in high quality marine plywood, Satin Varnish
- Hanse companionway closing system
- Saloon table, fixed with integrated storage
- Worktop in galley and heads - Grey

WOOD (FURNITURE, FLOORBOARD)

- Furniture - Mahogany Style, Satin Varnish
- Cupboard fronts coloured (selected fronts as per design - colour selection)
- Floorboard - Acacia

UPHOLSTERY

- Mattresses for all berths
- Upholstery - Monte Carlo, colour: Cream
- ST-Line upholstery in saloon

DECK & OUTSIDE EQUIPMENT

- GRP deck with antislip surface, isophthalic gelcoat, colour: Signal White (similar RAL 9003), 1st layer vinyl ester resin with PET foam core. 1 cockpit locker, 1 space for life raft, stern locker, stowage for running rigging at helm position, anchor locker at bow.

- Twin wheel steering system with emergency tiller
- 2 GRP steering wheels, Y-spoke (black or white)
- ST-Line cockpit table, stainless steel with folding teak tops
- Pulpit and pushpit, stainless steel, colour: black
- Railing, incl. black stanchions and black covered dyneema rope
- Covered halyards and control lines lead to cockpit helmposition, organizers and jammers, 6 black mooring cleats, black handrails on coach roof
- 2 LEWMAR 45 ST RACE EVO manual halyard winches
- 2 LEWMAR 45 ST RACE EVO manual secondary winches
- Swimming ladder
- Helmsman footrests (free mountable)
- Anchor windlass, electrical, with automatic fuse and remote control with chain counter
- Delta-anchor 16 kg, galvanized with 30 m galvanized chain
- Composite bowsprit with integrated anchor and forestay fitting with mooring roll incl. Crossover and Gennaker tack point
- Genoa tracks incl. cars, adjustable from cockpit
- Self tacking jib system
- German mainsheet system with adjustable traveller
- 2 large and 6 small deck hatches - openable, anchor locker hatch
- 4 large coach roof side windows - openable, 3 portlights in coach roof

RIG & SAILS

- Rig (ST-Line), anodized aluminium with dyform rigging, deck stepped, with kicker, standing and running rigging and 2 reefs and ST-Line backstay, adjustable from both sides
- Manual jib furler
- ELVSTRØM SPS performance sails - full battened, triradial main and jib
- Dyneema halyards for main and jib
- Mainsail slider system

NAVIGATION & INSTRUMENTS

- Illuminated compass in cockpit
- Navigation lights - LED

PROPULSION

- Fuel tank, approx. 160 l
- Engine (Diesel, approx. 29 hp) - saildrive, 2-blade fix propeller
- Spinlock removable throttle

EQUIPMENT

- 12 V and 230 V electric system with main panels and 230 V shore power and sockets in cabins and heads
- AGM battery set, capacity: 1x 90 Ah + 2x 160 Ah AGM
- Country Version: EU / AUS
- Battery charger
- Manual toilet with sea water flush - cabin layout C
- Shower unit in cockpit, warm-/coldwater
- Water akku for pressure equalization
- LPG gas system, stowage for 1 gas bottle
- Black water system (appr. 54 l each bathroom) with deck extraction and seacock for head, electric and manual bilge pump
- Fresh water system with electric pump and 20 l hot water, heated also by main engine
- Fresh water tank, appr. 345 l

ACCESSORIES

- Wind indicator
- Flagpole
- 6 fenders
- 4 mooring lines
- Add. winch handle
- Mast steps
- Hanse maintenance kit

SHIPPING & TRANSPORT

- CE - Certificate cat. A - 6
- Owners manual
- EC - Type Examination Certificate